

# LED STAIR WAY LIGHT

Data Sheet Document.

---

IP  
20

5Y  
WAR

7 W  
475 LMT

CRI  
>80

50.000  
HOURS







- |    |                 |
|----|-----------------|
| 01 | ORDER CODE      |
| 02 | DIMENSIONS (MM) |

- NSL-STAIR-5W-XXK-NS-IP65
- W48.25 H4.5

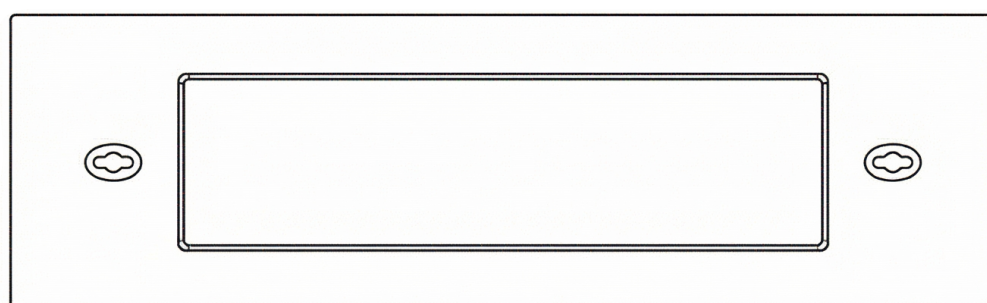
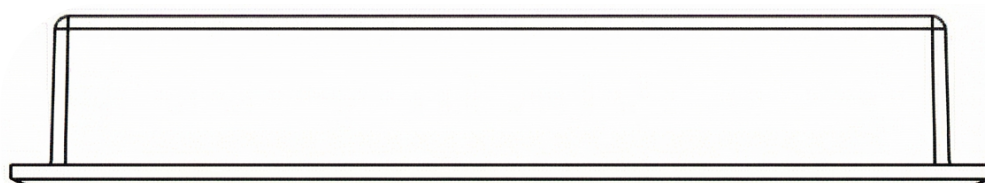
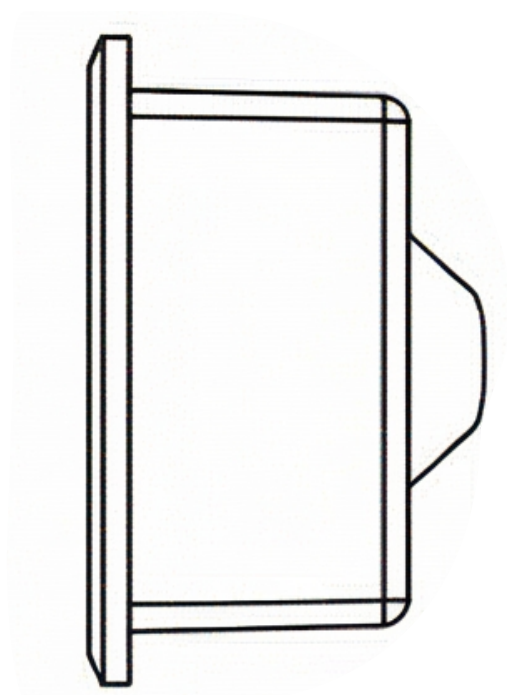

**03 GENERAL PRODUCT DISCRIPTION** Recessed LED lighting fixture designed for stairways, featuring a wide 160° beam angle and IP65 protection rating. Engineered to safely illuminate indoor and outdoor stair passages while maintaining a soft, glare-free visual experience. Ideal for wall-mounted integration in both residential and commercial environments.

**04 FEATURES** In most cases, lighting on staircases isn't purely a decorative theme it also serves a very real function in terms of safety. Glare should be avoided and maintenance considered, whilst using interior lighting to enhance the form can add beauty and softness.

<b>05 TECHNICAL DATA</b>	Input Voltage	220-240 V AC
	Frequency	50/60Hz
	Power Factor	>95%
	CCT	3000k, 4000k, 5000k,6000k
	CRI	>80%
	LED Efficiency	85-120Lm/W
	Power Supply	Tridonic / Nassli
	LED Type	Osram / Bridgelux
	Materials	Aluminum, PC, & Friendly material
	Beam Angle	160°
	Life Time	>50,000 Hour
	Operating Temp	-20°C to +55°C
	Storage Temp	-40°C to +85°C
	Certifications	CE, SELV and ISO
	Mounting	Recessed in Wall/Surface mounting
	IP Rating	IP65
	Dimmable	N/A
	Emergency	On Request
	Warranty	5 Years

**06 APPLICATIONS** It can be widely used for shopping malls, Palaces, Trade shows, Supermarkets, Conference Halls, Hotels, Schools, Hospitals, Meeting room Factories, Theater, Cinemas, Kitchens and Corridor etc ...



**07 PHOTOMETRIC DATA**

